

### KEY NOTES

- |    |                             |    |                                  |    |                     |
|----|-----------------------------|----|----------------------------------|----|---------------------|
| 02 | Structural Concrete Deck    | 41 | Approved Primer                  | 81 | Paver               |
| 08 | Equipment Support Stand Leg | 51 | AlphaGuard MT/MTS Base Coat      | 82 | Paver Pedestal      |
| 23 | Approved Insulation         | 61 | AlphaGuard Glass Mat or Permafab | 84 | AlphaGuard Flashing |
| 38 | Protection Sheet, Optional  | 71 | AlphaGuard MT/MTS Top Coat       | 94 | Equipment Support   |
| 39 | Drainage Board              |    |                                  | 96 | Bearing Plate Coat  |

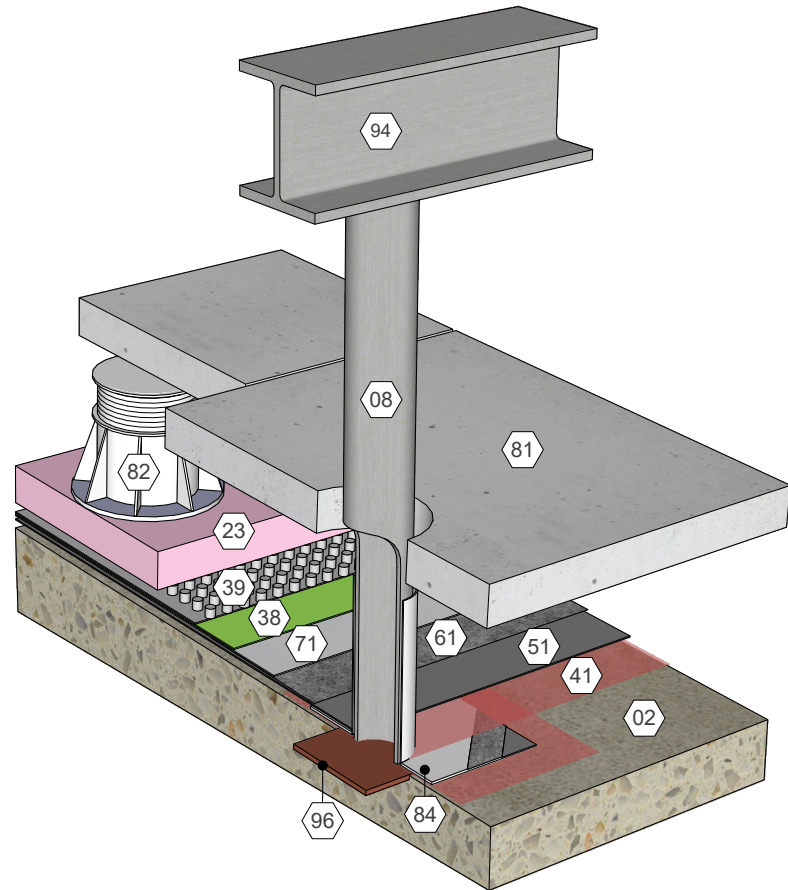

AlphaGuard® MT/MTS Plus Equipment Support Stand Leg Detail, Direct to Concrete  
Detail 10111

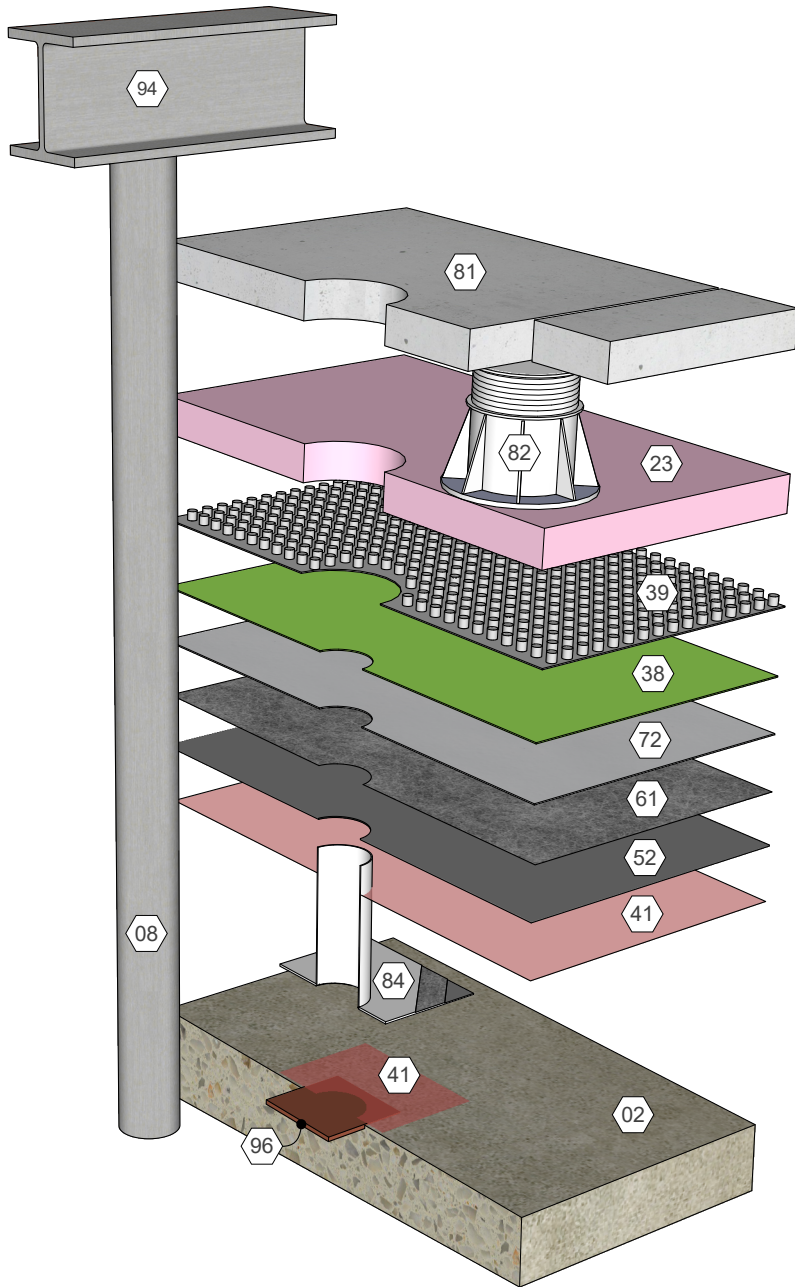

### KEY NOTES

- |                                |                                     |                        |
|--------------------------------|-------------------------------------|------------------------|
| 02 Structural Concrete Deck    | 41 Approved Primer                  | 81 Paver               |
| 08 Equipment Support Stand Leg | 52 AlphaGuard BIO Base Coat         | 82 Paver Pedestal      |
| 23 Approved Insulation         | 61 AlphaGuard Glass Mat or Permafab | 84 AlphaGuard Flashing |
| 38 Protection Sheet, Optional  | 72 AlphaGuard BIO Top Coat          | 94 Equipment Support   |
| 39 Drainage Board              |                                     | 96 Bearing Plate       |

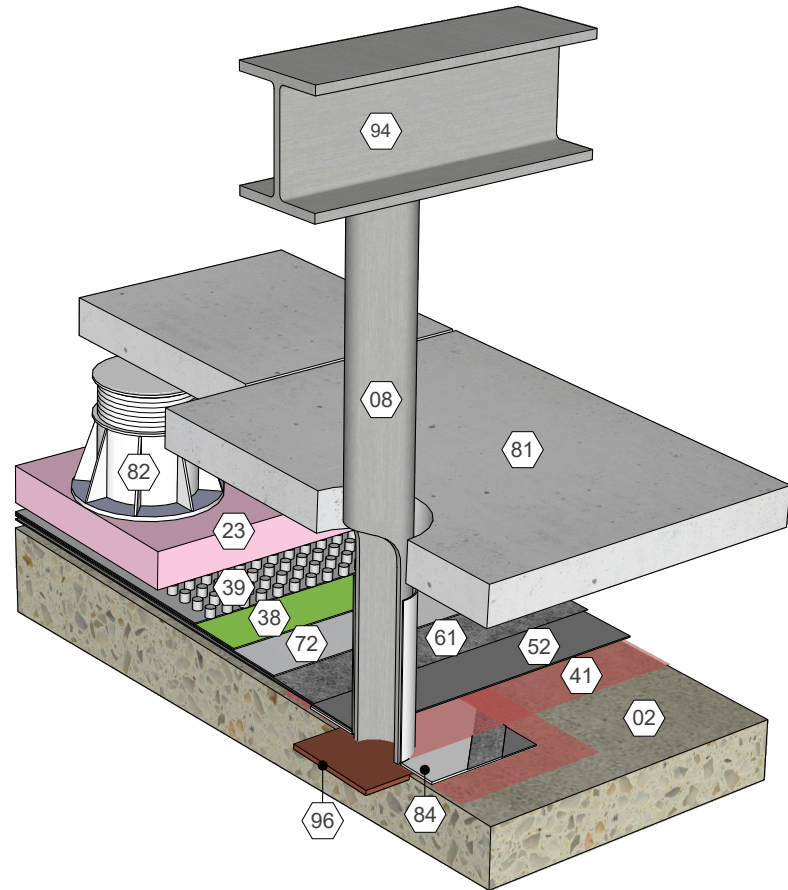

AlphaGuard® BIO Equipment Support Stand Leg Detail, Direct to Concrete  
Detail 10112

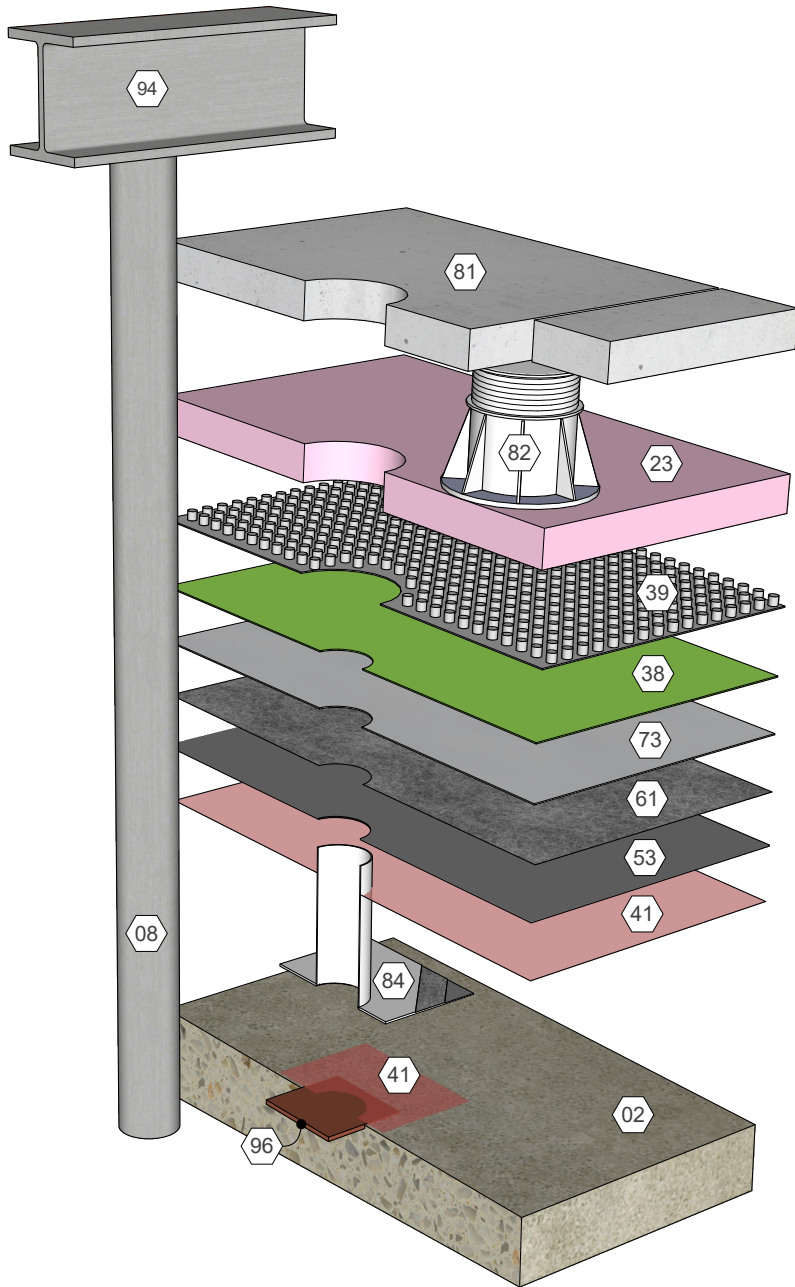

### KEY NOTES

- |                                |                                     |                        |
|--------------------------------|-------------------------------------|------------------------|
| 02 Structural Concrete Deck    | 41 Approved Primer                  | 81 Paver               |
| 08 Equipment Support Stand Leg | 53 AlphaGuard PUMA Base Coat        | 82 Paver Pedestal      |
| 23 Approved Insulation         | 61 AlphaGuard Glass Mat or Permafab | 84 AlphaGuard Flashing |
| 38 Protection Sheet, Optional  | 73 AlphaGuard PUMA Top Coat         | 94 Equipment Support   |
| 39 Drainage Board              |                                     | 96 Bearing Plate Coat  |

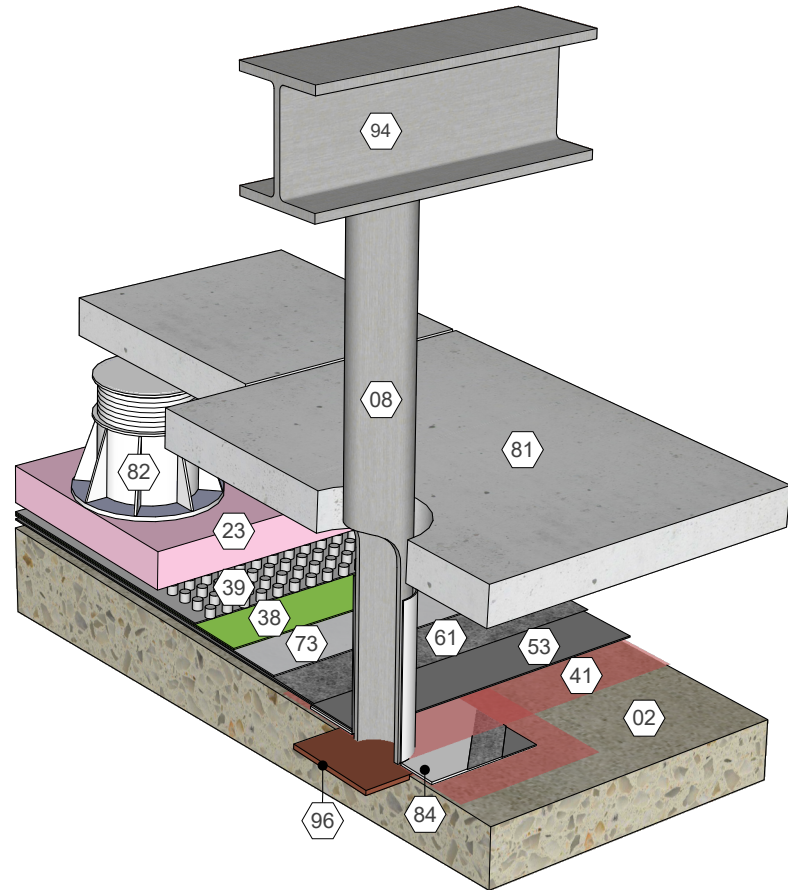

AlphaGuard® PUMA Equipment Support Stand Leg Detail, Direct to Concrete  
Detail 10113